

Compression & Tension Load Cell

> Model TX25

Model TX25 load cells measure both tension & compression load force. Applications include performance testers for automotive industry.

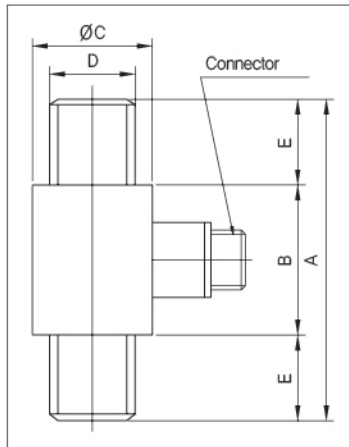

>SPECIFICATIONS

Specifications	Accuracy
Rated capacity(R.C)	100kgf~300tf (981N~2.942MN)
Rated output(R.O)	1mV/V±1%
Nonlinearity	0.15% of R.O.
Hysteresis	0.15% of R.O.
Repeatability	0.1% of R.O.
Creep	0.05% of R.O.
Zero balance	±1% of R.O.
Temperature effect on rated output	±0.01% of LOAD/10°C
Temperature effect on zero balance	±0.02% of R.O./10°C
Temperature range, compensated	-10°C to 60°C
Temperature range, safe	-20°C to 80°C
Terminal resistance, input	350Ω ±5%
Terminal resistance, output	350Ω ±5%
Insulation resistance bridge	2000MΩ
Excitation recommended	10V
Safe overload	120% R.C.
Cable length	Ø5mm, 4core, 3m

>DIMENSIONS TABLE

unit:mm

Model	Capacity	A	B	ØC	D	E	Weight(kg)
TX25-K100	100kgf (980.7N)	75	35	28	M16×1.5	20	0.5
TX25-K200	200kgf (1,961kN)	75	35	28	M16×1.5	20	
TX25-K500	500kgf (4,903kN)	75	35	28	M16×1.5	20	
TX25-T1	1tf (9,807kN)	75	35	28	M20×1.5	20	
TX25-T2	2tf (19,61kN)	75	35	28	M20×1.5	20	
TX25-T3	3tf (29,42kN)	75	35	28	M20×1.5	20	0.7
TX25-T5	5tf (49,03kN)	75	35	33	M24×2	20	
TX25-T10	10tf (98,07kN)	170	100	62.5	M39×2	35	2.5
TX25-T20	20tf (196,1kN)	190	90	63	M39×2	50	2.8
TX25-T50	50tf (490,3kN)	245	105	85	M64×2	70	7.5
TX25-T100	100tf (980,7kN)	340	140	115	M80×2	100	18
TX25-T200	200tf (1,961MN)	390	160	150	M110×2	115	36
TX25-T300	300tf (2,942MN)	450	194	169	M125×4	128	46

> Model TB25

Tension & compression load force.

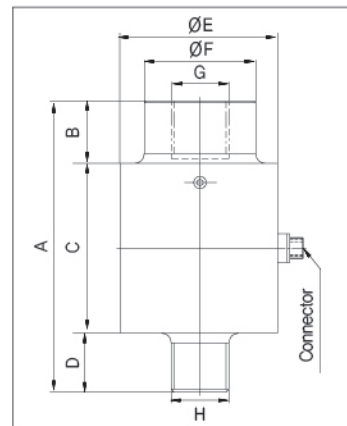
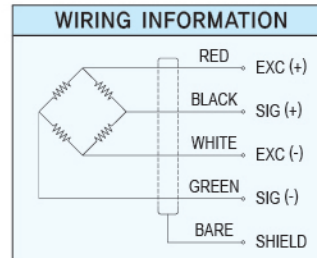
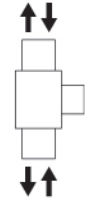

>SPECIFICATIONS

Specifications	Accuracy
Rated capacity(R.C)	1tf~300tf (9,807kN~2,942MN)
Rated output(R.O)	1~20tf : 1mV/V±2%, 50~300tf : 1.5mV/V±2%
Nonlinearity	0.15% of R.O.
Hysteresis	0.15% of R.O.
Repeatability	0.1% of R.O.
Creep	0.05% of R.O.
Zero balance	±1% of R.O.
Temperature effect on rated output	±0.03% of LOAD/10°C
Temperature effect on zero balance	±0.03% of R.O./10°C
Temperature range, compensated	-10°C to 50°C
Temperature range, safe	-20°C to 70°C
Terminal resistance, input	350Ω ±5%
Terminal resistance, output	350Ω ±5%
Insulation resistance bridge	2000MΩ
Excitation recommended	10V
Safe overload	120% R.C.
Cable length	Ø5mm, 4core, 3m

>DIMENSIONS TABLE

unit:mm

Model	Capacity	A	B	C	D	ØE	ØF	G	H	Weight(kg)
TB25-T1	1tf (9,807kN)	75	25.5	24.5	25	30	28	M20X1,5DP20	M20X1,5	0.5
TB25-T2	2tf (19,61kN)	75	25.5	24.5	25	30	28	M20X1,5DP20	M20X1,5	
TB25-T5	5tf (49,03kN)	173	30	100	43	55.5	42	M27X1,5DP40	M27X1,5	3
TB25-T10	10tf (98,07kN)	173	30	100	43	62.5	42	M27X1,5DP40	M27X1,5	
TB25-T20	20tf (196,1kN)	196	62.5	87.5	45	62.5	52	M33X2DP53	M33X2	5
TB25-T50	50tf (490,3kN)	295	50	190	55	120	78	M48X2DP55	M48X2	15
TB25-T100	100tf (980,7kN)	355	80	200	75	176	116	M72X6DP75	M72X2	35
TB25-T150	150tf (1,470MN)	385	125	170	90	150	130	M90X6DP90	M90X2	30
TB25-T200	200tf (1,961MN)	465	135	220	110	190	170	M110X6DP115	M110X2	58
TB25-T300	300tf (2,942MN)	496	143	200	153	200	185	M125X4DP125	M125X2	80

★ Specifications are subject to change without notice.